

The Spring Collection.

**NOBILIS**<sup>®</sup>  
The Best Technology for Water

## Index

03	Intro
04	Overview
16	Collection
18	Dimensions
20	Technology
22	Group

## **Memory and dream.**

The Spring Collection. A magical fusion between memory and dream. The traditional form of the past harmoniously melts with the modernity of the planning mark. A constant evolution which is wisely connected to the past. An evolution which does not forget the technological heritage of more than fifty years.

Opposite

Single hole basin mixer

SP57118/1 CR

Available finishes

CR Chrome



Opposite

3-hole basin mixer

SP57011/1 CR

Available finishes

CR Chrome



Opposite

3-hole built-in basin mixer

SP57198 CR

Available finishes

CR Chrome



Opposite

External bath/shower mixer

SP57001 CR

Available finishes

CR Chrome



Opposite

External shower thermostatic mixer

SP00030/2 CR

Available finishes

CR Chrome



Opposite

Single hole sink mixer

SP57113 CR

Available finishes

CR Chrome





SP57118/1 CR  
Single hole basin mixer, swivel spout, anti-limestone aerator M 26 x 1, waste 1 1/4",  $\varnothing$  3/8" stainless steel flexible hoses.

SP57128/1 CR  
Single hole high basin mixer, swivel spout, anti-limestone aerator M 26 x 1, waste 1 1/4",  $\varnothing$  3/8" stainless steel flexible hoses.

SP57119/1 CR  
Single hole bidet mixer, swivel spout, adjustable jet, anti-limestone aerator M 26 x 1, waste 1 1/4",  $\varnothing$  3/8" stainless steel flexible hoses.

SP57011/1 CR  
3-hole basin mixer, stainless steel flexible hoses, swivel spout, anti-limestone aerator M 26 x 1, waste 1 1/4",  $\varnothing$  3/8" stainless steel flexible hoses.

SP57198 CR  
3-hole built-in basin mixer, anti-limestone aerator M 26 x 1, without waste.

SP57015/1 CR  
3-hole bidet mixer, swivel spout, adjustable jet, anti-limestone aerator M 26 x 1, waste 1 1/4",  $\varnothing$  3/8" stainless steel flexible hoses.

SP57001/6 CR  
4-hole bath mixer for deck mounting, automatic diverter, anti-limestone aerator M 26 x 1, 1-jet pull-out hand shower.

SP57001 CR  
External bath/shower mixer, wheelbase  $150 \pm 15$ , automatic diverter, anti-limestone aerator M 26 x 1, 1-jet hand shower, adjustable support.

SP57003/1 CR  
External shower mixer, wheelbase  $150 \pm 15$ , 1/2" connection.



SP00010/2 CR  
External bath/shower thermostatic mixer, wheelbase  $150 \pm 20$ , safety block at  $38^{\circ}\text{C}$ , anti-limestone aerator M 24 x 1, 1-jet hand shower.

SP00010 CR  
External bath/shower thermostatic mixer, wheelbase  $150 \pm 20$ , safety block at  $38^{\circ}\text{C}$ , anti-limestone aerator M 24 x 1, 1/2" connection.

SP00030/2 CR  
External shower thermostatic mixer, wheelbase  $150 \pm 20$ , safety block at  $38^{\circ}\text{C}$ , 1-jet hand shower.

SP00030/30 CR  
External shower column thermostatic mixer, wheelbase  $150 \pm 20$ , safety block at  $38^{\circ}\text{C}$ , adjustable shower head  $\varnothing 200$  mm, 1-jet hand shower.

SP00030 CR  
External shower thermostatic mixer, wheelbase  $150 \pm 20$ , safety block at  $38^{\circ}\text{C}$ , 1/2" connection.

SP57004/2 CR  
Single hole basin mixer, anti-limestone aerator M 16 x 1, without waste.

SP57113 CR  
Single hole sink mixer, swivel spout, anti-limestone aerator M 26 x 1,  $\varnothing 3/8$ " stainless steel flexible hoses.

SP57300/3 CR  
Single hole sink mixer, swivel spout, 2-jets adjustable hand shower,  $\varnothing 3/8$ " stainless steel flexible hoses.

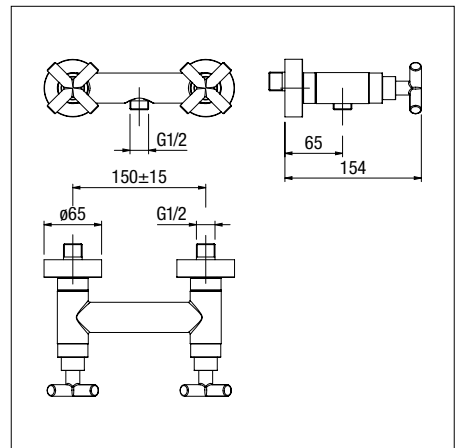
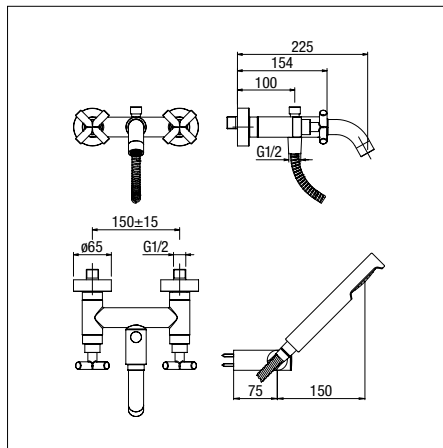
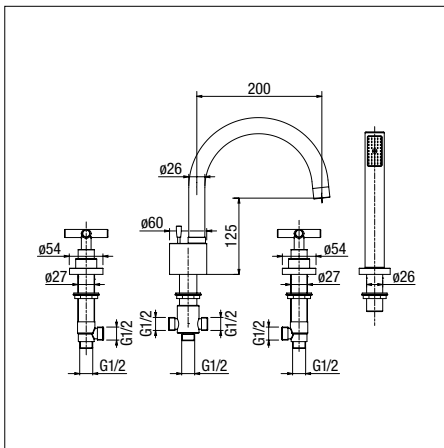
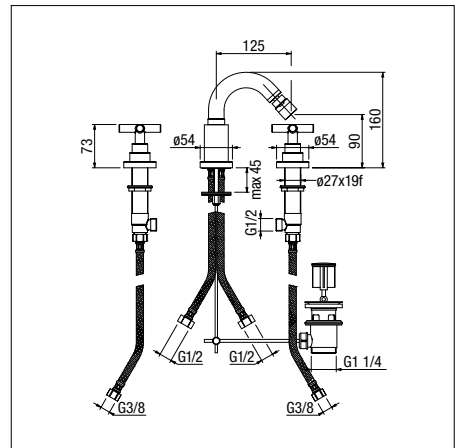
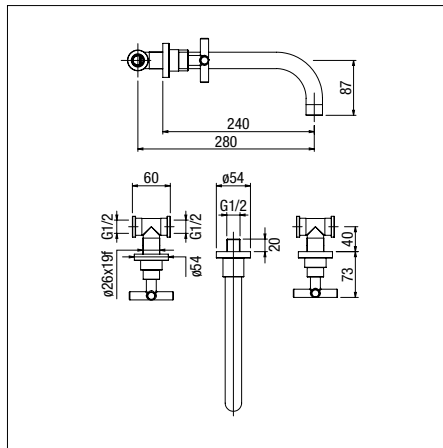
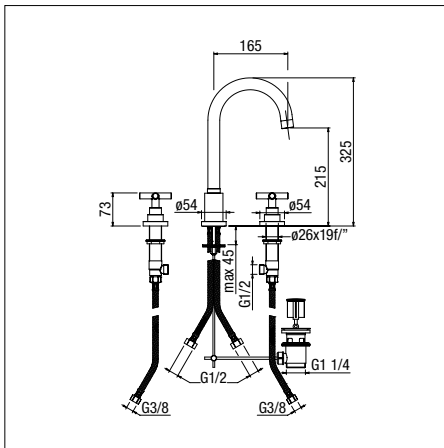
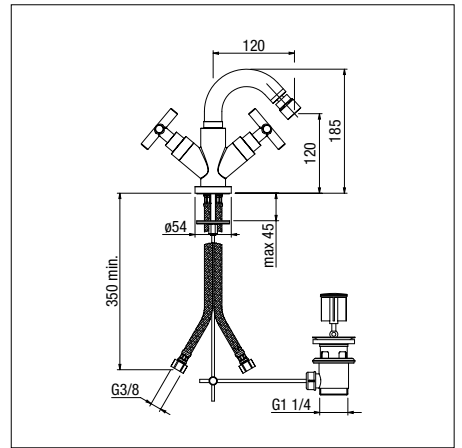
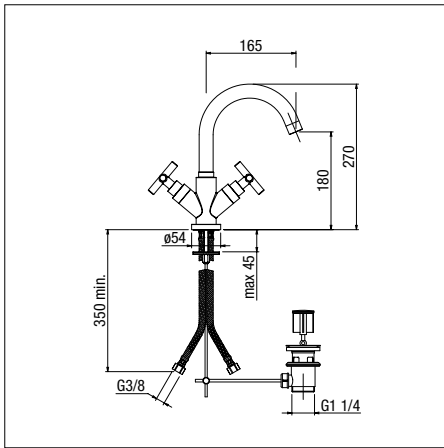

- SP57118/1      SP57128/1      SP57119/1
- SP57011/1      SP57198          SP57015/1
- SP57001/6      SP57001          SP57003/1

Dimensions are expressed in mm.

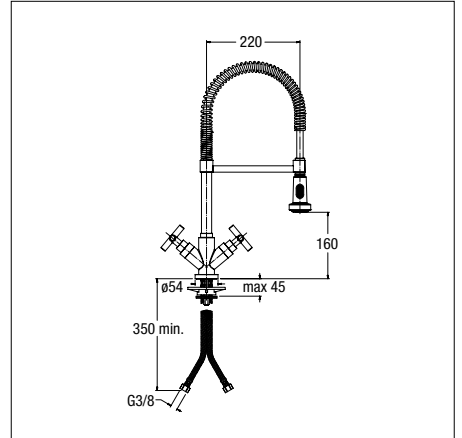
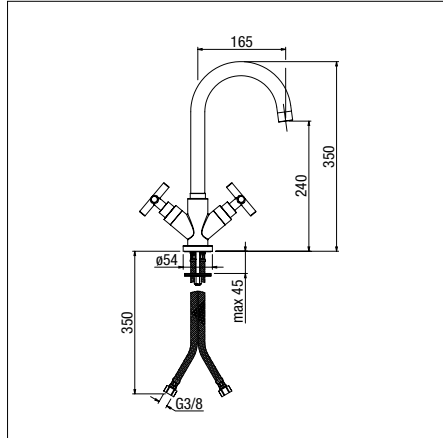
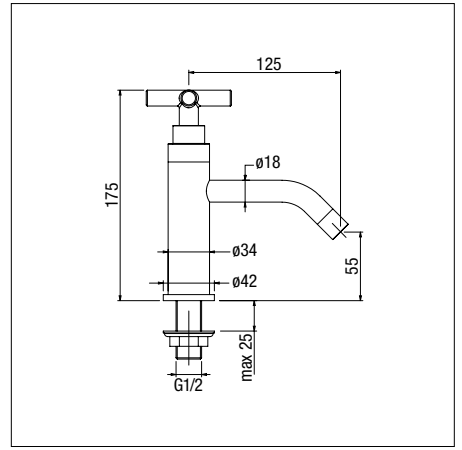
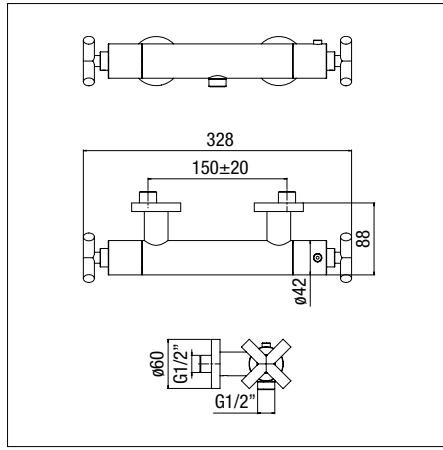
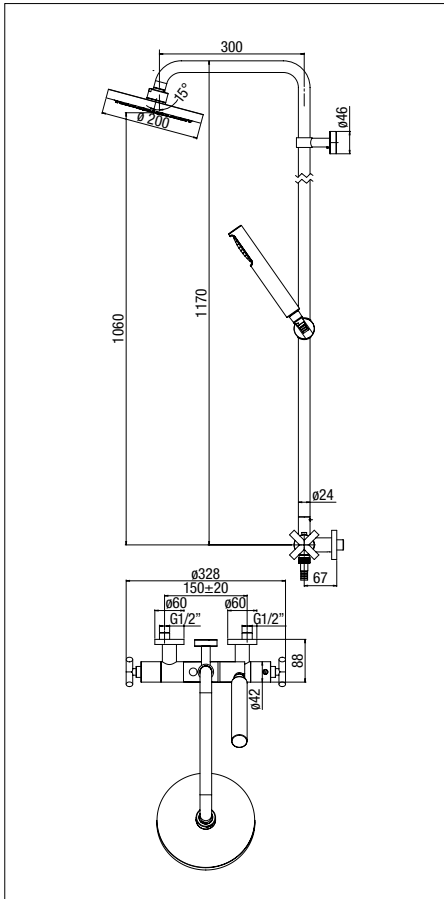
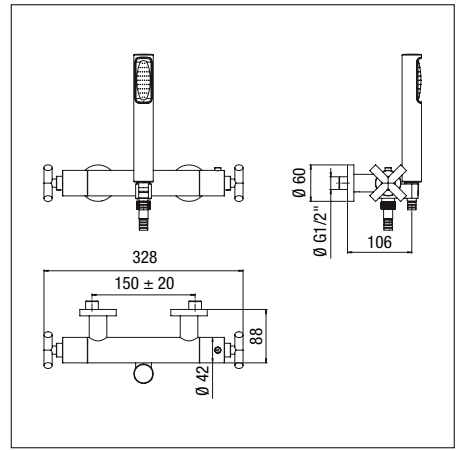
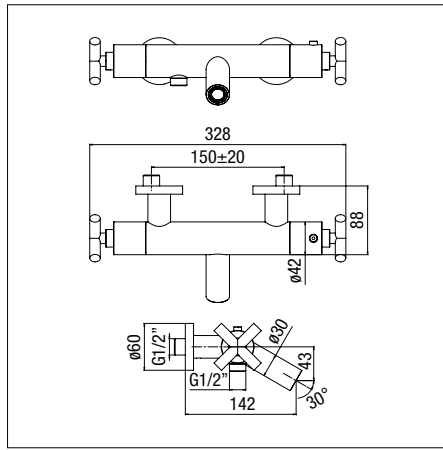
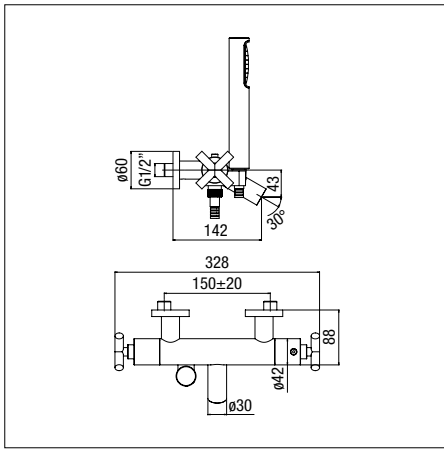

- |            |         |           |
|------------|---------|-----------|
| SP00010/2  | SP00010 | SP00030/2 |
| SP00030/30 | SP00030 | SP57004/2 |
|            | SP57113 | SP57300/3 |

Dimensions are expressed in mm.

- The ceramic headwork that regulates the water flow is realized with materials, process and clever device so to grant a smooth handling and a major life time when working at high temperatures.
- As for further improvements of product quality level, the components are submit to an annealing thermic treatment that allows to obtain a major homogeneity of material.
- Best care is reserved to OR and base washer, that are made from alimentary rubber, therefore with mixtures to stand wear and tear and also resistant to high temperature, in order to not undergo to dimensional modification in time.
- Valuable element, the Cascade® aerator maintains a full and dense water supply, in every kind of condition. In order to reduce wastage of water you can ask for a different aerator which limits the waterflow.
- Listen to the sound of water. It is often an underestimated element, but a distinctive mark for Nobili. The excellent connection of the mechanical parts assures a great acoustic comfort.
- Notice the bright finish of Nobili mixers. Smooth and shiny surfaces are provided by our chrome plating values, decidedly higher with respect to the standard: 15.0 µm Nickel and 0.5 µm Chrome.

Every day, engineers researchers and technicians conceive and test our technology. We imagine the finished product as it was an organism, an harmonious whole of various components. A sound of perfect synchrony. Nothing is left up to fate. Even the smallest and most hidden element is worth our full attention. It is important, whatever its function. Each component is treated in detail by people who love their profession. Different people operate on different parts. Every specific detail must be simple, realiable, beautiful, inside and outside. For these reasons we are sure that Nobili product is extraordinary. Downright.





Established away back in 1954, Carlo Nobili Rubinetterie is today a modern Company with high quality standards, one of a kind among the international taps and mixers producers worldwide, and attentive to the market and the people's needs. The production space consists of three hundred and fifty thousand square meters, fifty thousand indoor, ten production plants, two hundred million euro made in last year's turnover. More than sixty series in the catalogue, all of them conceived and produced in the three hundred in-house machining centers, with the care and the passion reserved for precious items, in full compliance with "Made in Italy". In the world nothing great has been created without passion, the same passion that makes us think about innovation, every day. Eight international patents obtained in the last five years, ten worldwide reputed designers, who cooperate with Nobili Centro Stile. Professionalism, know-how, flexibility and promptness: a quick prototyping center allows us to continuously study new forms and get the most out of the material. Without wastes. The three eco-compatible galvanic system are equipped in compliance with the most restrictive anti-pollution norms. A product that was studied to improve the quality of life cannot exist if it ruins the world we live in. Right and proper. All this is Nobili. Follow us.

Concept, script, art direction: Centro Stile Nobili

Teknobili Collection  
Design: Centro Stile Nobili

Carlo Nobili SpA Rubinetterie  
S.S. 229 Km. 19+600, 28019 Suno (No) Italia  
T. +39 0322 885885 / F. +39 0322 858091  
info@nobili-spa.com / www.nobili-spa.com



Respect the environment. Don't throw me away.  
Re-use me or deliver me to a friend.

The images, technical details and characteristics of the models listed in the following brochure are subjected to changes, detailed and substantive, without notice, with the sole aim of further improving the product. Because catalogues are prepared and printed in a certain period of time before the actual distribution of the item, is not always possible to provide detailed descriptions of specific details. You should always check the technical details before purchasing, especially if the choice depends significantly from any of the techniques shown here.

**NOBILIS**®  
The Best Technology for Water

